

# COMPANY PROFILE / 公司介绍

Welcome to Qingdao Conston Medical Technology Co.,Ltd.

Based in Qingdao, China, we are a medical devices manufacture specializing in the production of high-quality ligating clips, clip applicators, disposable laparoscopic instruments, trocars, aortic punches, and more. All our products have CE and ISO 13485, assuring our products meet the highest international standards. We also offer OEM and customization services for all our products. Our company is equipped with the capability to research and develop new medical devices, ensuring innovation and staying at the forefront of the industry. In addition to manufacturing, we provide procurement services, facilitating the sourcing of materials and components on behalf of our clients.

Choose Conston Medical for unparalleled quality, innovation, and a commitment to your success in the medical field.



# PRODUCT INTRODUCTION / 产品介绍

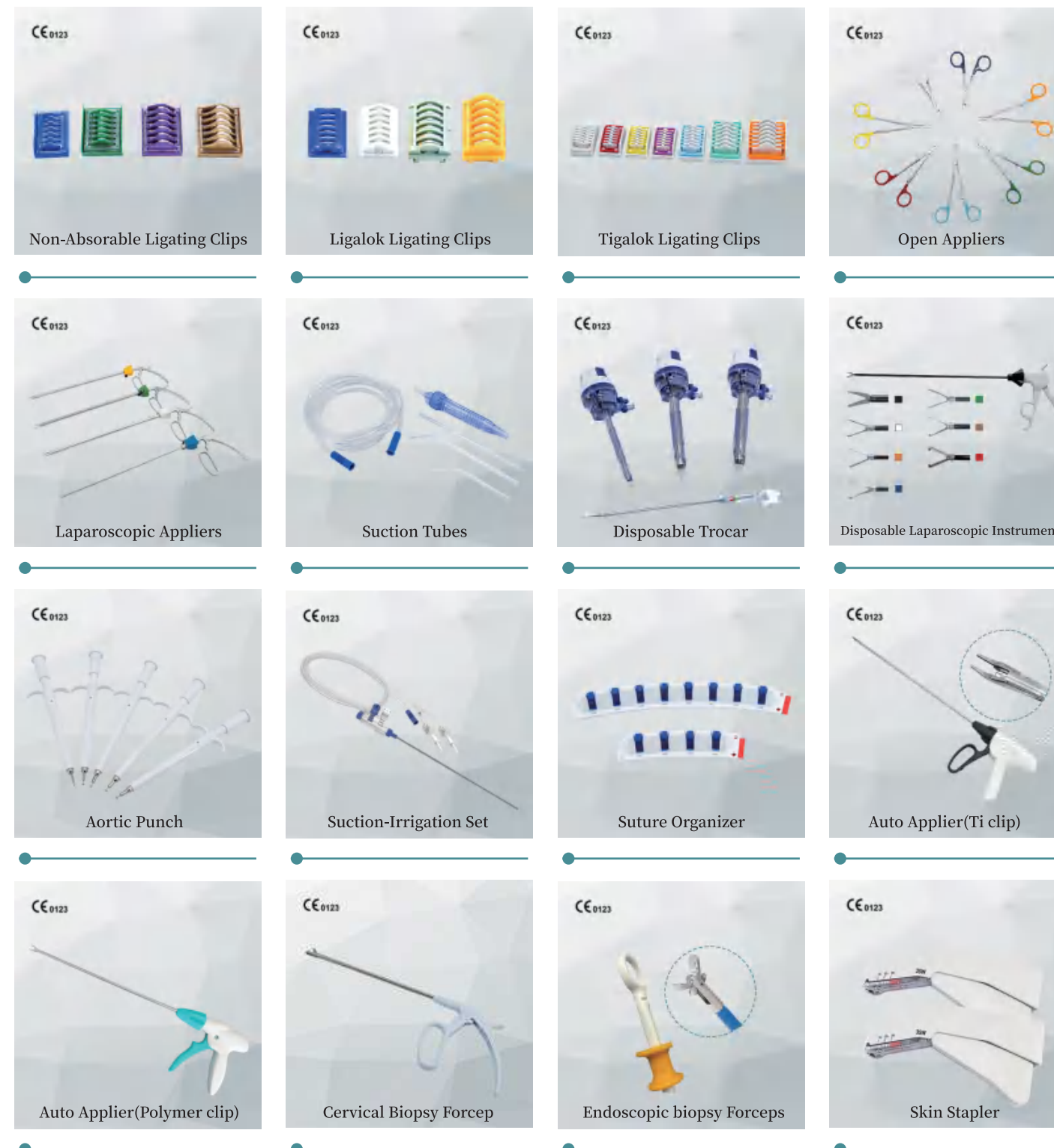

**Qingdao Conston Medical Technology Co.,Ltd**

青岛康仕顿医疗科技有限公司  
Tel:0086-17685870558  
E-mail: info@conston-tech.com  
Web: www.conston-tech.com  
CE 0123 ISO13485



# TIGA-LOK LIGATING CLIPS

一次性使用组织闭合夹



QINGDAO CONSTON MEDICAL TECHNOLOGY CO.,LTD  
青岛康仕顿医疗科技有限公司

# PRODUCT INTRODUCTION / 产品介绍

## >> 产品名称 | TIGA-LOK LIGATING CLIPS

| REF         | Size         | Colour | Pcs Cartridge | Cartridge box |
|-------------|--------------|--------|---------------|---------------|
| TCTL5200    | Micro        |        | 6             | 40            |
| TCTL1200    | Small        |        | 6             | 40            |
| TCTL1201    | Small        |        | 6             | 40            |
| TCTL1202    | Small-Medium |        | 6             | 40            |
| TCTL2200    | Medium       |        | 6             | 30            |
| TCTL3200    | Medium-Large |        | 6             | 20            |
| TCTL4200    | Large        |        | 6             | 14            |
| TCTL1200-24 | Set-Yellow   |        | 24            | 14            |
| TCTL1201-24 | Set-ST       |        | 24            | 14            |
| TCTL2200-24 | Set-MT       |        | 24            | 14            |

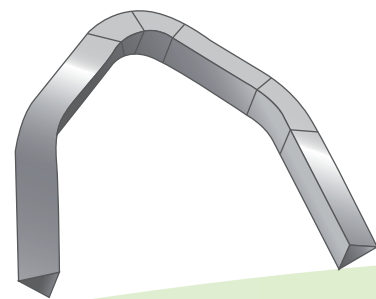

# TIGA-LOK OPEN APPLIER / 产品介绍

## >> 产品名称 | TIGA-LOK OPEN APPLIER

| Size         | Ref         | Length(mm) |
|--------------|-------------|------------|
| Micro        | TATL5200-15 | 150        |
|              | TATL5200-20 | 200        |
|              | TATL5200-28 | 280        |
| Small-Yellow | TATL1200-15 | 150        |
|              | TATL1200-20 | 200        |
|              | TATL1200-28 | 280        |
| Small-Red    | TATL1201-15 | 150        |
|              | TATL1201-20 | 200        |
|              | TATL1201-28 | 280        |
| Small-Medium | TATL1202-15 | 150        |
|              | TATL1202-20 | 200        |
|              | TATL1202-28 | 280        |
| Medium       | TATL2200-15 | 150        |
|              | TATL2200-20 | 200        |
|              | TATL2200-28 | 280        |
| Medium-Large | TATL3200-15 | 150        |
|              | TATL3200-20 | 200        |
|              | TATL3200-28 | 280        |
| Large        | TATL4200-15 | 150        |
|              | TATL4200-20 | 200        |
|              | TATL4200-28 | 280        |



## >> 产品名称 TIGA-LOK LAPAROSCOPIC APPLIER

| Size         | Ref        | Detachable  | Length |
|--------------|------------|-------------|--------|
| Medium       | TATL2200E2 | Two Parts   | 330    |
|              | TATL2200E3 | Three Parts | 330    |
| Medium Large | TATL3200E2 | Two Parts   | 330    |
|              | TALT3200E3 | Three Parts | 330    |
| Large        | TALT4200E2 | Two Parts   | 330    |
|              | TALT4200E3 | Three Parts | 330    |

